

NORTH CAROLINA DEPARTMENT OF TRANSPORTATION  
DIVISION OF HIGHWAYS

PROPOSED SUBDIVISION ROAD CONSTRUCTION  
STANDARD CERTIFICATION

APPROVED \_\_\_\_\_  
DISTRICT ENGINEER

This the \_\_\_\_\_ Day of \_\_\_\_\_ 2006  
NORTH CAROLINA - FORSYTH COUNTY

PLANNING DEPARTMENT/REVIEW OFFICER  
FINAL SUBDIVISION PLAT APPROVAL

This is to certify that this plat meets the recording requirements of the Unified Development Ordinance Subdivision Regulations for Winston-Salem, Forsyth County.

I, David E. Reed, Review Officer of Forsyth County, certify that the map or plat to which this certification is affixed meets all statutory requirements for recording.

Approved \_\_\_\_\_  
Mayor of Planning/Review Officer

This the 23 day of March, 2006  
NORTH CAROLINA - FORSYTH COUNTY

SURVEYORS CERTIFICATION

I, John E. Beeson, certify that this plat was drawn under my supervision from an actual survey made under my supervision (Description recorded in Deed Book \_\_\_\_\_ or Plat Book \_\_\_\_\_ Page \_\_\_\_\_ if applicable); that the ratio of precision as calculated is 1: 10,000; that this plat was prepared in accordance with G.S. 47-50 as amended; Witness my original signature, registration number and seal this 23 day of March, A.D., 2006.

John E. Beeson, L-1028  
Surveyor  
NORTH CAROLINA - FORSYTH COUNTY

I, John E. Beeson, Professional Land Surveyor, Number 1828 certify to one of the following as indicated by an X:

a. That this plat is of a survey that creates a subdivision of land within the area of a county or municipality that has an ordinance that regulates parcels of land;

b. That this plat is of a survey that is located in such portion of a county or municipality that is unregulated as to an ordinance that regulates parcels of land;

c. That this plat is of a survey of an existing parcel or parcels of land;

d. That this plat is of a survey of another category, such as the recombination of existing parcels, a court-ordered survey or other exception to the definition of a subdivision; and

e. That the information available to this surveyor is such that I am unable to make a determination to the best of my professional ability as to provisions contained in a through d. above.

John E. Beeson, L-1028  
Surveyor  
NORTH CAROLINA - FORSYTH COUNTY

FORSYTH COUNTY REGISTER OF DEEDS  
PLAT REGISTRATION

Filed for Registration at 2:40 o'clock P  
This the 23 day of March, 2006 and recorded  
in Plat Book 50, Page 8

Witness the Seal of John C. Wood, Register of Deeds  
By [Signature]  
Deputy - Assistant

The undersigned hereby acknowledge that I am (we are) the owner(s) of the property shown and described hereon and that I (we) hereby adopt this plan and subdivision with my (our) free consent and upon approval by the city-county planning board of Winston-Salem and Forsyth County authorize that this plat be recorded in the office of the register of deeds of Forsyth County.

5-23-06 signed Bruce R. Hubbard, Inc.  
Date Hubbard Realty of Winston-Salem, Inc.

3-23-06 signed Muriel Patterson, v. Inc.  
Date McCuire Construction Co. Inc.

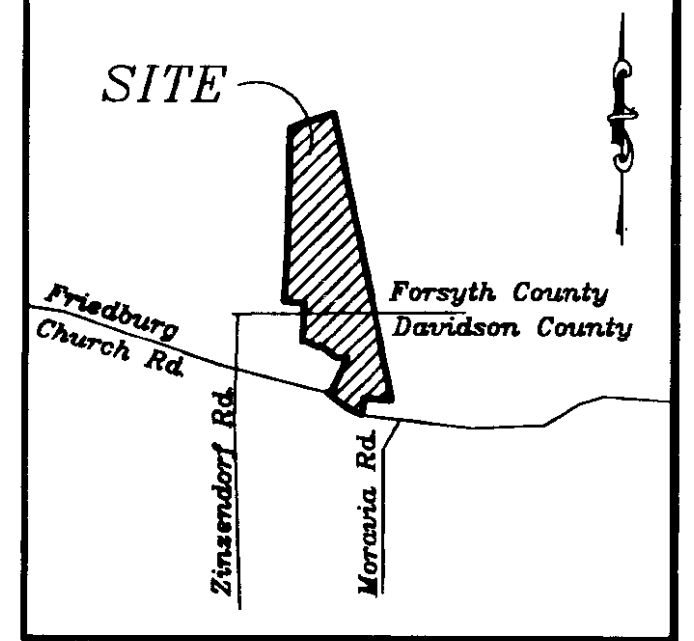
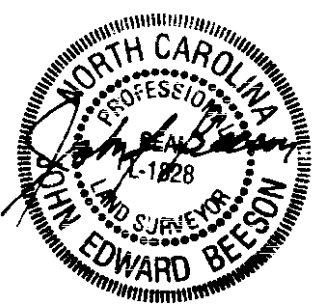

Now or Formerly  
Tax Lot 8D, Block 3882  
Luther E. Snyder  
DB 1124, Pg 115

Now or Formerly  
Lot 49  
Maxine H. Snyder  
DB 509, Pg 669

BLK	LOT	MLOT	PN	STNAM	STTYPE
3882A	017	17	8812-80-9284.00	156	COBALT CT
3882A	018	18	8812-80-9128.00	141	COBALT CT
3882A	021	21	8812-80-7183.00	286	QUICK SILVER DR
3882A	022	22	8812-80-7251.00	304	QUICK SILVER DR
3882A	023	23	8812-80-7248.00	310	QUICK SILVER DR
3882A	024	24	8812-80-7314.00	316	QUICK SILVER DR
3882A	028	28	8812-80-7478.00	1880	IRONSTONE CT
3882A	029	29	8812-80-8468.00	1970	IRONSTONE CT

CURVE	LENGTH	RADIUS	BEARING	CHORD
C7	22.23	14.50	S06°08'10"E	20.12
C8	19.98	23.50	S63°06'44"W	18.38
C9	16.50	50.00	N78°02'55"E	16.42
C10	84.20	50.00	N31°48'50"E	59.08
C11	50.26	50.00	N33°45'59"W	48.17
C12	41.32	50.00	N86°14'21"W	40.16
C13	59.47	50.00	S60°00'32"E	56.03
C14	10.34	50.00	S03°56'38"E	10.32
C15	19.96	23.50	N14°28'08"E	19.36
C16	24.57	14.50	N87°19'53"E	21.75
C17	228.45	935.00	S37°07'41"E	227.89
C18	56.55	935.00	S28°06'21"E	56.54
C19	76.01	935.00	S23°43'16"E	75.99
C20	72.23	935.00	S19°10'45"E	72.21
C21	59.57	935.00	S14°15'18"E	59.54
C22	116.61	935.00	S07°54'18"E	116.63
C23	76.68	935.00	S01°58'56"E	76.68
C24	54.98	935.00	S02°03'04"W	54.96
C25	21.21	13.50	S48°44'08"W	19.09
C26	16.54	525.00	S87°10'09"E	16.54
C27	73.53	525.00	N87°55'05"E	73.47
C28	46.28	525.00	N61°22'47"E	46.28
C29	19.96	23.50	N78°47'27"E	19.36
C30	33.50	50.00	S71°37'39"E	32.87
C31	40.84	50.00	N83°48'56"E	39.71
C32	41.46	50.00	N18°37'50"E	40.28
C33	44.11	50.00	N30°23'39"W	42.89
C34	41.19	50.00	N79°15'58"W	40.03
C35	41.01	50.00	S53°38'19"W	39.87
C36	19.98	23.50	N54°29'56"E	19.36
C37	97.73	475.00	N84°44'53"E	97.56
C38	25.84	475.00	S87°48'41"E	25.84
C39	25.19	13.50	S32°49'12"E	21.88
C107	51.12	275.00	S15°17'59"W	51.04
C108	29.95	275.00	S06°51'17"W	29.93
C109	12.12	985.00	S03°22'57"W	12.12
C110	71.11	985.00	S00°57'42"W	71.09
C111	55.98	985.00	S03°01'19"E	55.94
C112	83.78	985.00	S06°47'30"E	83.75
C113	90.87	985.00	S10°59'32"E	90.85
C114	88.28	985.00	S15°19'28"E	88.27
C116	72.70	985.00	S19°25'29"E	72.68
C116	116.87	985.00	S24°56'17"E	116.80
C117	107.58	985.00	S31°27'58"E	107.53
C118	89.02	985.00	S37°11'02"E	88.98
C119	89.49	985.00	S42°22'32"E	89.45
C120	90.21	985.00	S47°36'07"E	90.18
C121	18.92	985.00	S50°43'04"E	18.92
C122	153.65	225.00	N31°38'48"W	150.89
C123	21.21	13.50	N32°54'58"E	19.09
C124	250.92	375.00	S58°44'49"W	246.27

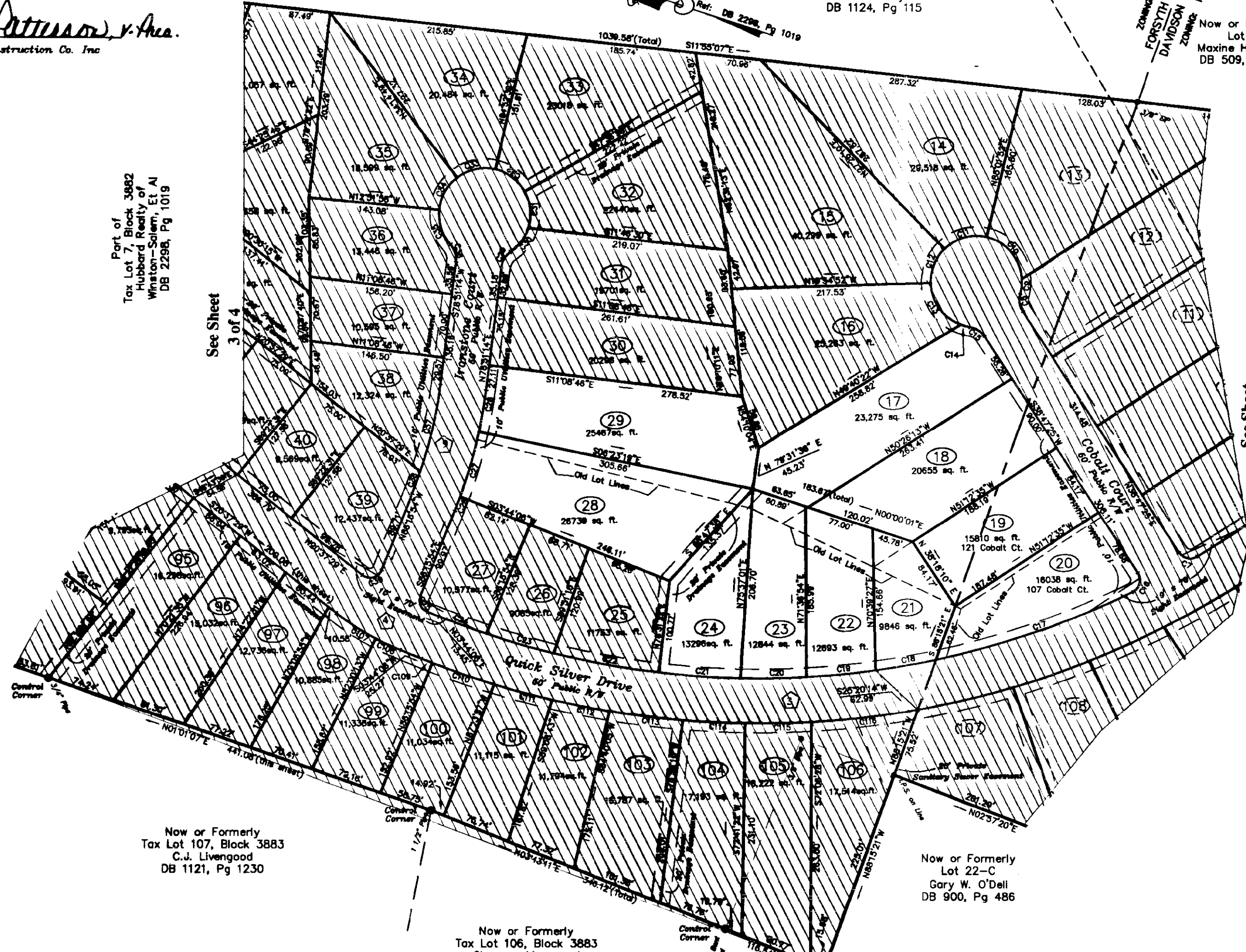

Now or Formerly  
Tax Lot 107, Block 3883  
C.J. Livengood  
DB 1121, Pg 1230

Now or Formerly  
Tax Lot 106, Block 3883  
Clarence Livengood  
DB 673, Pg 270

Now or Formerly  
Lot 22-C  
Gary W. O'Dell  
DB 900, Pg 486

CENTERLINE CURVE DATA				
CURVE	LENGTH	RADIUS	BEARING	CHORD
3	90.61	980.00	S23°44'14"E	885.73
4	73.70	250.00	N12°10'48"E	73.43
9	129.86	500.00	N86°17'40"E	128.50

NOTE: This survey is subject to any facts that may be disclosed by a full and accurate title search, NOT furnished to me as of this date, and may be subject to easements, rights-of-way, restrictive covenants, assessments, if any, as the same may appear of record in the Office of the Register of Deeds, Clerk of Court, Town or County Tax Office or which may have been acquired by prescriptive use.

Section 1  
Total Lots: 113  
Lots in Davidson County: 19  
Lots in Forsyth County: 90 (Zoned RS-9)  
Lots in Forsyth & Davidson Counties: 4

Total Acreage:  
Acreage in Davidson County: 15.58ac  
677,952 sq.ft

Acreage in Forsyth County: 35.97ac  
1,666,761 sq.ft

LEGEND  
EIP.....Existing Iron Pipe Found w/sise  
NIP.....New 3/4" Iron Pipe Set  
Stone.....Old Planted Field Stone Found  
REBAR.....Existing Steel Reinforcing Rod found w/sise  
Pt.....Point on Ground, no monument found or set  
NAE.....Negative Access Easement

Revised 03/20/2006 by JDB

The purpose of the rerecording of this plat is to correct the dimensions and areas of the following lots 17, 18, 19, 20, 21, 22, 23, 24, 28 & 29 previously recorded in PB 49, Pgs. 174-177.  
Revised 01/31/2006 by JDB  
Previously Recorded in PB, 49, Pg. 141-144

# 02059

Second Revision  
**BORDER CREEK**

Owner/Developer  
Hubbard Realty of Winston-Salem Inc  
McCuire Construction Co. Inc

2110 Cloverdale Ave.  
Winston-Salem, NC 27103  
(336) 725-0303

SCALE: 1" = 100'

FIELD WORK BY: CJ  
CHECKED BY: JEB

TAX MAP: Davidson Co. Tax Map No. 2  
Forsyth Co. Tax Map No. 018822

PANEL: Davidson Co. Lots 13, 22 & 25  
Forsyth Co. Lot: 7, 21 3883

TOWNSHIP: Arcadia  
South Fork

CITY: South Fork

COUNTY: Davidson  
Forsyth

STATE: NC  
DATE: 12-10-2006  
SHEET NUMBER: 2 of 4

JOB NUMBER: 02209  
DRAWN BY: TLBN

**BEESON ENGINEERING INC.**  
ENGINEERS SURVEYORS PLANNERS

603 HIGH STREET  
WINSTON-SALEM, NC 27101  
TELEPHONE: 336-748-0071  
WWW.BEESONENGINEERING.COM

BOOK 50 PAGE 8

Revised recorded plat in Forsyth County PB 50, Pg 8  
And recorded in Davidson County PB 47, Pg 37

NORTH CAROLINA DEPARTMENT OF TRANSPORTATION  
DIVISION OF HIGHWAYS  
PROPOSED SUBDIVISION ROAD CONSTRUCTION  
STANDARDS CERTIFICATION

APPROVED \_\_\_\_\_  
DISTRICT ENGINEER

This the \_\_\_\_\_ Day of \_\_\_\_\_ 20\_\_\_\_  
NORTH CAROLINA - DAVIDSON COUNTY

PLANNING DEPARTMENT/REVIEW OFFICER  
FINAL SUBDIVISION PLAT APPROVAL

This is to certify that this plat meets the recording requirements of the Development Ordinance Subdivision Regulations for Davidson County.

I, Guy L. Coraman, III, Review Officer of Davidson County, certify that the map or plat to which this certification is affixed meets all statutory requirements for recording.

Approved Guy L. Coraman, III  
Director of Planning/Review Officer  
This the 11 day of April, 2006  
NORTH CAROLINA - DAVIDSON COUNTY

SURVEYORS CERTIFICATION

I, John E. Beeson, certify that this plat was drawn under my supervision from an actual survey made under my supervision (description recorded in Deed Book \_\_\_\_\_ Page \_\_\_\_\_ or Plat Book \_\_\_\_\_ Page \_\_\_\_\_ if applicable); that the ratio of precision as calculated is 1: 10,000; that this plat was prepared in accordance with G.S. 47-30 as amended. Witness my original signature, registration number and seal this 11 day of APRIL, A.D. 2006.

John E. Beeson  
Surveyor  
L-1828  
Registration Number

NORTH CAROLINA - FORSYTH COUNTY

I, John E. Beeson, Professional Land Surveyor, Number 1828 certify to one of the following as indicated by an X:

a. That this plat is of a survey that creates a subdivision of land within the area of a county or municipality that has an ordinance that regulates parcels of land;

b. That this plat is of a survey that is located in such portion of a county or municipality that is unregulated as to an ordinance that regulates parcels of land;

c. That this plat is of a survey of an existing parcel or parcels of land;

d. That this plat is of a survey of another category, such as the recombination of existing parcels, a court-ordered survey or other exception to the definition of a subdivision.

That the information available to this surveyor is such that I am unable to make a determination to the best of my professional ability as to provisions contained in a through d. above.

John E. Beeson  
Surveyor  
L-1828  
Registration Number

NORTH CAROLINA - FORSYTH COUNTY

DAVIDSON COUNTY REGISTER OF DEEDS  
PLAT REGISTRATION

Filed for Registration at \_\_\_\_\_ o'clock \_\_\_\_\_ M  
This the \_\_\_\_\_ Day of \_\_\_\_\_, 20\_\_\_\_ and recorded in Plat Book \_\_\_\_\_ Page \_\_\_\_\_

Filing Fee Paid: \_\_\_\_\_  
By \_\_\_\_\_ Deputy - Assistant

I hereby certify that the subdivision plat shown hereon has been found to comply with the Subdivision Regulations to Davidson County, North Carolina, and that this plat has been approved by the Planning Board/Board of County Commissioners for recording in the office of the Register of Deeds of Davidson County.

4-11-06 Steve Long Guy L. Coraman, III  
Date Chairman Subdivision Administrator

ANY DEVELOPMENT OR CONSTRUCTION ON THE LOTS SHOWN ON THIS PLAT MUST MEET ALL BUILDING AND DEVELOPMENT REGULATIONS OF THE APPROPRIATE LOCAL GOVERNMENTAL UNIT OR AGENCY.

4-11-06 Guy L. Coraman, III Steve Long  
Date Subdivision Administrator / Chairman, Planning Board

The undersigned hereby acknowledge that I am (we are) the owners of the property shown and described hereon and that I (we) hereby adopt this plan and subdivision with my (our) free consent and upon approval by the city-county planning board of Winston-Salem and Forsyth County authorize that this plat be recorded in the office of the register of deeds of Forsyth County

4-10-06 signed Gene Hubbard  
Date Hubbard Realty of Winston-Salem Inc

4-10-06 signed Norris Patterson, V. Ann  
Date McGuire Construction Co. Inc

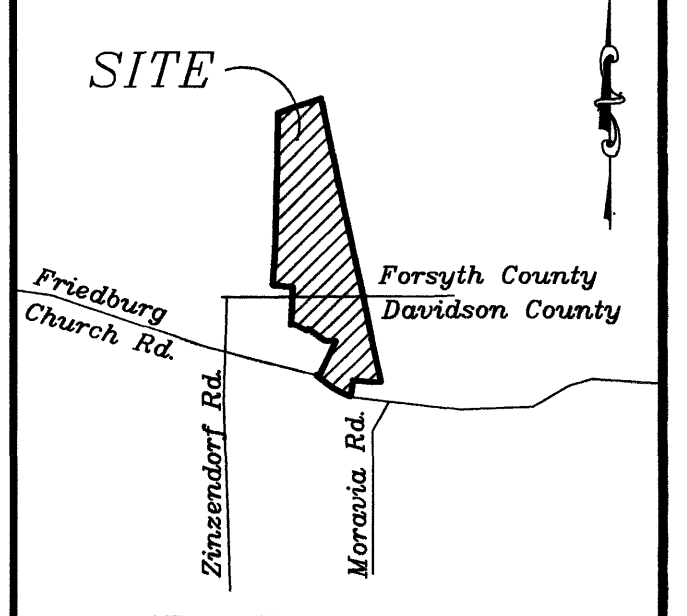
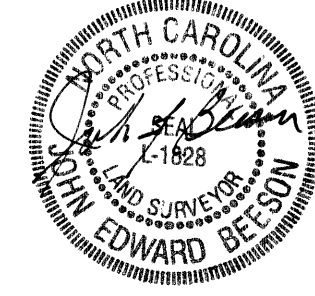

BLK	LOT	M.LOT	PIN	STNUM	STNAME	STTYPE
3882A	017	17	8812-80-81264.00		COBALT	CT
3882A	018	18	8812-80-81268.00	141	COBALT	CT
3882A	021	21	8812-80-7183.00	296	QUICK SILVER DR	
3882A	022	22	8812-80-7251.00	304	QUICK SILVER DR	
3882A	023	23	8812-80-7245.00	310	QUICK SILVER DR	
3882A	024	24	8812-80-7314.00	316	QUICK SILVER DR	
3882A	028	28	8812-80-7478.00	1980	IRONSTONE	CT
3882A	029	29	8812-80-8468.00	1970	IRONSTONE	CT

CURVE	LENGTH	RADIUS	BEARING	CHORD
C7	22.23	14.50	S05°08'10"E	20.12
C8	19.98	23.50	S63°08'44"W	19.38
C9	16.50	50.00	N78°02'55"E	16.42
C10	64.20	50.00	N31°48'50"E	59.88
C11	50.26	50.00	N33°45'59"W	48.17
C12	41.32	50.00	N86°14'21"W	40.16
C13	59.47	50.00	S36°00'32"W	56.03
C14	10.34	50.00	S03°56'38"E	10.32
C15	19.98	23.50	N14°28'08"E	19.38
C16	24.57	14.50	N87°19'53"E	21.73
C17	228.45	935.00	S37°07'41"E	227.89
C18	66.55	935.00	S28°05'21"E	66.54
C19	76.01	935.00	S23°43'16"E	75.99
C20	72.23	935.00	S19°10'45"E	72.21
C21	89.57	935.00	S14°15'18"E	89.54
C22	116.61	935.00	S07°54'16"E	116.53
C23	76.68	935.00	S01°58'56"E	76.66
C24	54.96	935.00	S02°03'04"W	54.95
C25	21.21	13.50	S48°44'06"W	19.09
C26	16.54	525.00	S87°10'03"E	16.54
C27	73.53	525.00	N87°55'05"E	73.47
C28	48.28	525.00	N81°22'47"E	48.28
C29	19.98	23.50	N76°47'27"W	19.38
C30	33.50	50.00	S71°37'39"E	32.87
C31	40.84	50.00	N65°46'56"E	39.71
C32	41.46	50.00	N18°37'50"E	40.28
C33	44.11	50.00	N30°23'39"W	42.69
C34	41.19	50.00	N79°15'58"W	40.03
C35	41.01	50.00	S63°38'19"W	39.87
C36	19.98	23.50	N54°29'56"E	19.38
C37	97.73	475.00	N84°44'53"E	97.56
C38	25.64	475.00	S87°48'41"E	25.64
C39	25.19	13.50	S32°49'12"E	21.69
C107	51.12	275.00	S15°17'59"W	51.04
C108	29.95	275.00	S08°51'17"W	29.93
C109	12.12	985.00	S03°22'57"W	12.12
C110	71.11	985.00	S00°57'42"W	71.09
C111	65.86	985.00	S03°01'19"E	65.84
C112	63.76	985.00	S06°47'30"E	63.75
C113	80.67	985.00	S10°59'32"E	80.65
C114	68.28	985.00	S15°19'28"E	68.27
C115	72.70	985.00	S19°25'29"E	72.68
C116	116.87	985.00	S24°56'17"E	116.80
C117	107.58	985.00	S31°27'58"E	107.53
C118	89.02	985.00	S37°11'02"E	88.99
C119	89.49	985.00	S42°22'32"E	89.45
C120	90.21	985.00	S47°36'07"E	90.18
C121	16.92	985.00	S50°43'04"E	16.92
C122	153.65	225.00	N31°38'48"W	150.88
C123	21.21	13.50	N32°54'58"E	19.09
C124	250.92	875.00	S58°44'49"W	246.27

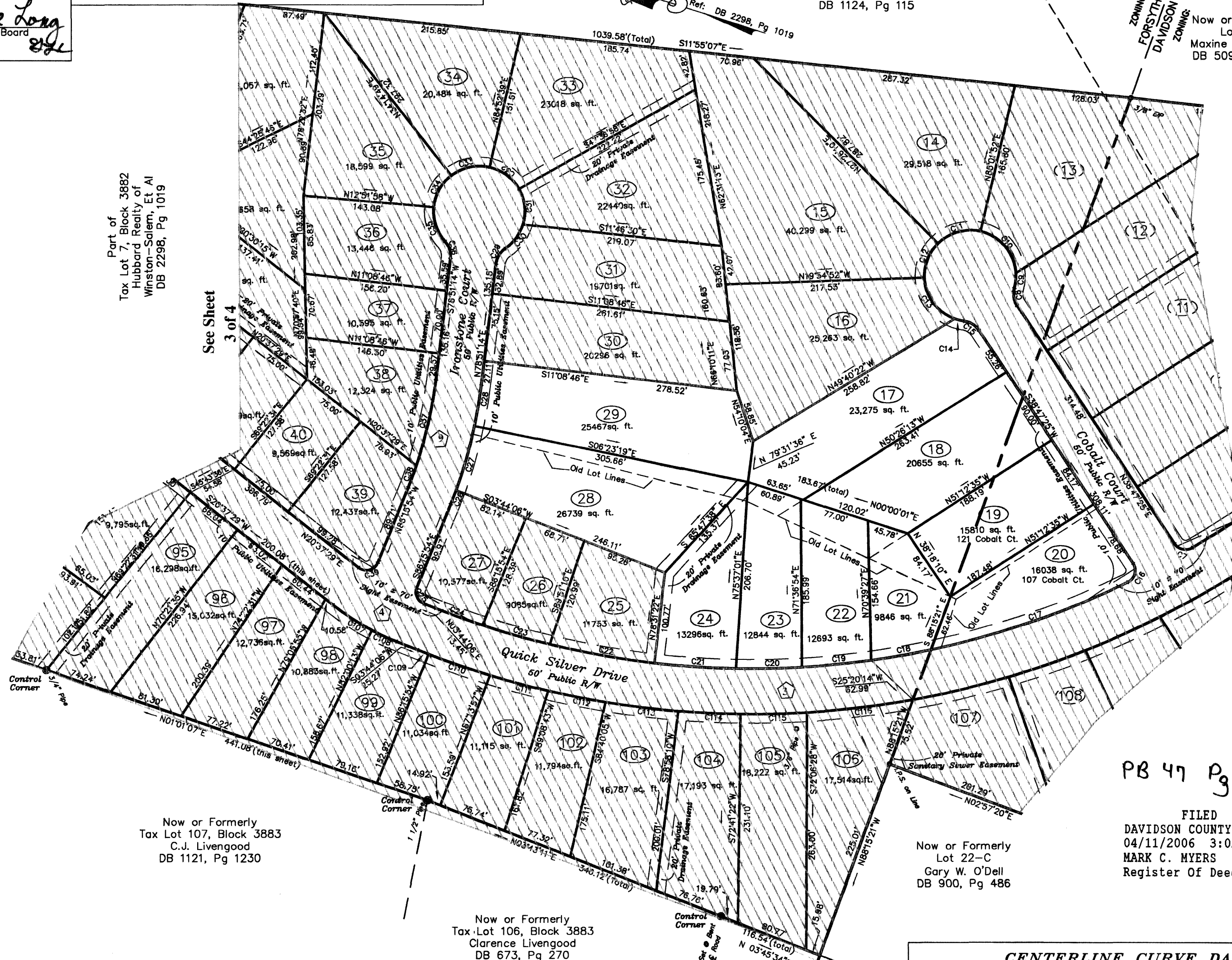

Now or Formerly  
Tax Lot 107, Block 3883  
C.J. Livengood  
DB 1121, Pg 1230

Now or Formerly  
Tax Lot 106, Block 3883  
Clarence Livengood  
DB 673, Pg 270

Now or Formerly  
Tax Lot 49  
Maxine H. Snyder  
DB 509, Pg 669

Now or Formerly  
Lot 22-C  
Gary W. O'Dell  
DB 900, Pg 486

CURVE	LENGTH	RADIUS	BEARING	CHORD
3	920.61	960.00	S23°44'14"E	885.73
4	73.70	250.00	N12°10'48"E	73.43
9	129.86	500.00	N86°17'40"E	129.50

FILED  
DAVIDSON COUNTY NC  
04/11/2006 3:02 PM  
MARK C. MYERS  
Register of Deeds

NOTE:

This survey is subject to any facts that may be disclosed by a full and accurate title search, NOT furnished to me as of this date, and may be subject to easements, rights-of-way, restrictive covenants, assessments, if any, as the same may appear of record in the Office of the Register of Deeds, Clerk of Court, Town or County Tax Office or which may have been acquired by prescriptive use.

Section 1  
Total Lots: 113  
Lots in Davidson County: 19  
Lots in Forsyth County: 90 (Zoned RS-9)  
Lots in Forsyth & Davidson Counties: 4

Total Acreage:  
Acreage in Davidson County: 15.56ac±  
677,952 sq.ft

Acreage in Forsyth County: 35.97ac±  
1,566,751 sq.ft.

- LEGEND
- EIP.....Existing Iron Pipe Found w/size  
NIP.....New 3/4" Iron Pipe Set  
Stone.....Old Planted Field Stone Found  
REBAR.....Existing Steel Reinforcing Rod found w/size  
Pt.....Point on Ground, no monument found or set  
NAE.....Negative Access Easement

The purpose of the rerecording of this plat is to correct the dimensions and areas of the following lots: 17, 18, 19, 20, 21, 22, 23, 24, 28 & 29. Previously Recorded in PB 46, Pg. 89.

Revised 04/07/2006 by DAS

# 02059

Revised  
**BORDER CREEK**

Owner/Developer  
Hubbard Realty of Winston-Salem Inc  
McGuire Construction Co. Inc

2110 Cloverdale Ave.  
Winston-Salem, NC 27103  
(886) 723-0303

SCALE: 1" = 100'  
0 50 100 200

FIELD WORK BY: CJ	CHECKED BY: JEB
TAX MAP: Davidson Co. Tax Map No. 2 Forsyth Co. Tax Map No. 818822	PARCEL: Davidson Co. Lots 13, 22 & 25 Forsyth Co. Lot 7, Bl 3882
TOWNSHIP: Arcadia South Fork	CITY: Davidson Forsyth
STATE: NC	DATE: 12-10-2005
JOB NUMBER: 02209	DRAWN BY: TLBN
SHEET NUMBER: <b>2 of 4</b>	

**BEESON ENGINEERING INC.**  
ENGINEERS SURVEYORS PLANNERS  
508 HIGH STREET  
WINSTON-SALEM, NC 27101  
TELEPHONE: 336-748-0071  
WWW.BEESONENGINEERING.COM

NORTH CAROLINA DEPARTMENT OF TRANSPORTATION  
DIVISION OF HIGHWAYS  
PROPOSED SUBDIVISION ROAD CONSTRUCTION  
STANDARD CERTIFICATION  
APPROVED \_\_\_\_\_ DISTRICT ENGINEER  
This the \_\_\_\_ Day of \_\_\_\_\_ 2006  
NORTH CAROLINA - Davidson County

PLANNING DEPARTMENT/REVIEW OFFICER  
FINAL SUBDIVISION PLAT APPROVAL  
This is to certify that this plat meets the recording requirements of the Unified Development Ordinance Subdivision Regulations for Winston-Salem, Davidson County.  
Reviewed by: David E Reed  
Review Officer of Davidson County, certify that the map or plat to which this certification is affixed meets all statutory requirements for recording.  
Approved: David Reed  
Director of Planning/Review Officer  
This the 16 day of February 2006  
NORTH CAROLINA - FORSYTH COUNTY

SURVEYORS CERTIFICATION  
I, JOHN E. BEESON certify that this plat was drawn under my supervision from an actual survey made under my supervision (description recorded in Deed Book \_\_\_\_\_ Page \_\_\_\_\_ or Plat Book \_\_\_\_\_ if applicable); that the ratio of precision as calculated is 1:10000; that this plat was prepared in accordance with G.S. 47-30 as amended. Witness my original signature, registration number and seal this 15 day of FEB, A.D., 2006.  
John E. Beeson L-1828  
Surveyor Registration Number  
NORTH CAROLINA - FORSYTH COUNTY

I, JOHN E. BEESON Professional Land Surveyor, Number 1828 certify to one of the following as indicated by an X:  
a. That this plat is of a survey that creates a subdivision of land within the area of a county or municipality that has an ordinance that regulates parcels of land.  
b. That this plat is of a survey that is located in such portion of a county or municipality that is unregulated as to an ordinance that regulates parcels of land.  
c. That this plat is of a survey of an existing parcel or parcels of land.  
d. That this plat is of a survey of another category, such as the recombination of existing parcels, a court-ordered survey or other exception to the definition of a subdivision. That the information available to this surveyor is such that I am unable to make a determination to the best of my professional ability as to provisions contained in through g. above.  
X a  
John E. Beeson L-1828  
Surveyor Registration Number  
NORTH CAROLINA - FORSYTH COUNTY

FORSYTH COUNTY REGISTER OF DEEDS  
PLAT REGISTRATION  
Filed for Registration at 8:47 a'clock A  
This the 17 day of Feb, 2006 and recorded in Plat Book 4-9, Page 174  
Filing Fee Paid: \$21  
Indie C Wood/Rd.  
S. Campbell  
Deputy Registrar

CURVE	LENGTH	RADIUS	BEARING	CHORD
C1	37.61	325.00	S42°53'35"W	37.59
C2	173.84	325.00	S61°31'55"W	171.78
C3	6.02	325.00	S77°23'09"W	6.02
C4	21.21	13.50	S57°05'02"E	19.09
C5	71.16	275.00	N19°29'50"W	70.96
C6	116.63	275.00	N39°03'38"W	115.76
C7	22.23	14.50	S05°08'10"E	20.12
C8	19.98	23.50	S63°08'44"W	19.38
C9	16.50	50.00	N78°02'55"E	16.42
C10	64.20	50.00	N31°48'50"W	59.88
C11	50.26	50.00	N33°45'59"W	48.17
C12	41.32	50.00	N86°14'21"W	40.16
C13	59.47	50.00	S36°00'32"W	56.03
C14	10.34	50.00	S03°59'38"E	10.32
C15	19.98	23.50	N14°28'06"E	19.38
C16	24.57	14.50	N87°19'53"E	21.73
C17	228.45	935.00	S37°07'41"E	227.89
C18	66.55	935.00	S28°05'21"E	66.54
C117	107.58	985.00	S31°27'58"E	107.53
C118	89.02	985.00	S37°11'02"E	88.99
C119	89.49	985.00	S42°22'32"E	89.45
C120	90.21	985.00	S47°38'07"E	90.18
C121	16.92	985.00	S50°43'04"E	16.92
C122	153.65	225.00	N31°38'48"W	150.68
C123	21.21	13.50	N32°54'56"E	19.09
C124	250.92	375.00	S56°44'49"W	248.27

I hereby certify that the subdivision plat shown herein has been found to comply with the Subdivision Regulations for Davidson County, North Carolina, and that this plat has been approved by the Planning Board/Board of County Commissioners for recording in the office of the Register of Deeds of Davidson County.

Date \_\_\_\_\_ Chairman \_\_\_\_\_ Subdivision Administrator \_\_\_\_\_

ANY DEVELOPMENT OR CONSTRUCTION ON THE LOTS SHOWN ON THIS PLAT MUST MEET ALL BUILDING AND DEVELOPMENT REGULATIONS OF THE APPROPRIATE LOCAL GOVERNMENTAL UNIT OR AGENCY.

Date \_\_\_\_\_ Subdivision Administrator / Chairman, Planning Board \_\_\_\_\_

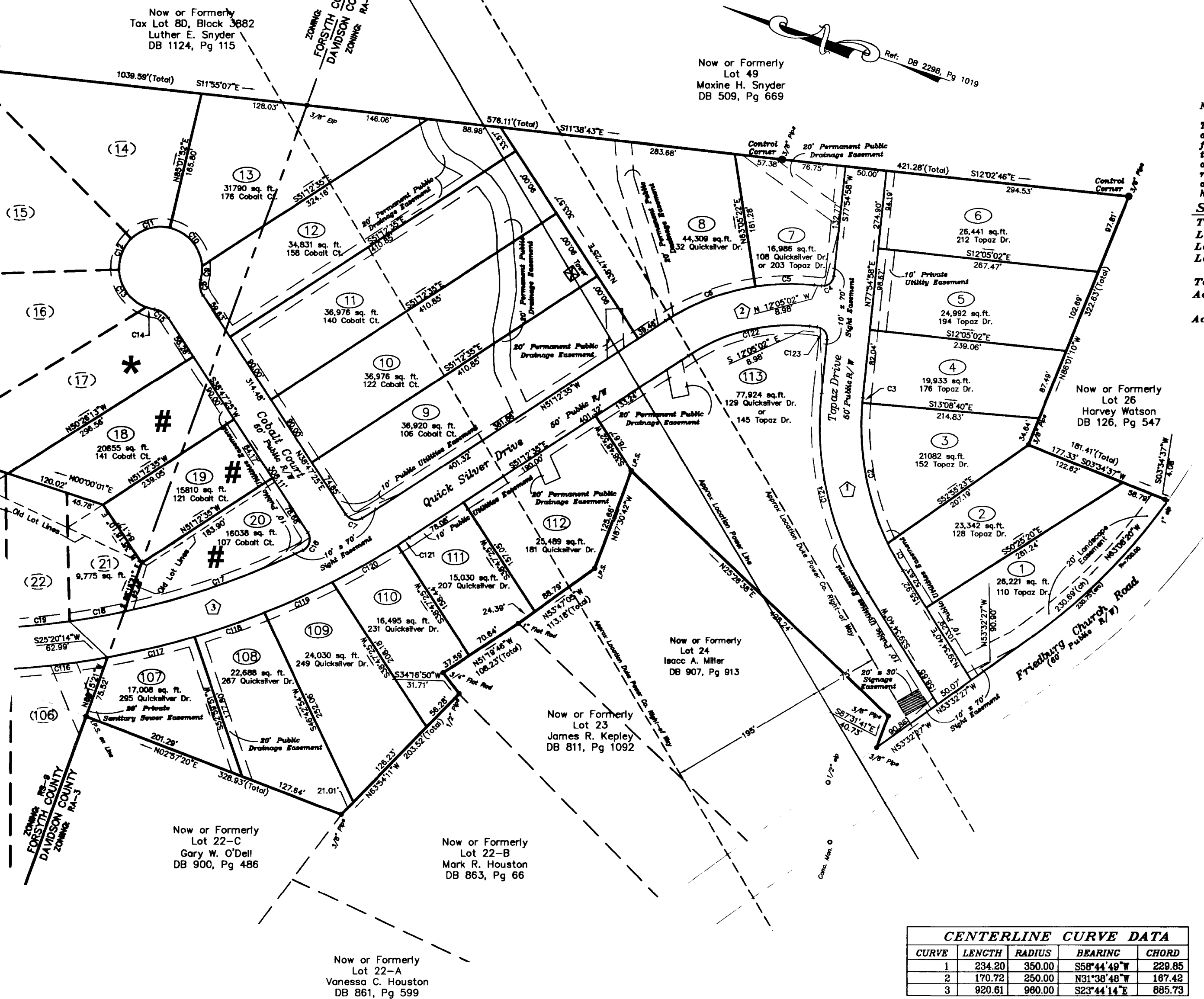

Now or Formerly Tax Lot 8D, Block 3882 Luther E. Snyder DB 1124, Pg 115

Now or Formerly Lot 4 Snyder DB 509, Pg 669

Now or Formerly Lot 22-B Gary W. O'Dell DB 900, Pg 486

Now or Formerly Lot 23 James R. Kepley DB 811, Pg 1092

Now or Formerly Lot 22-A Vanessa C. Houston DB 861, Pg 599

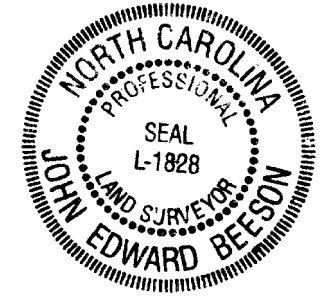

The undersigned hereby acknowledge that I am (we are) the owners of the property shown and described herein and that I (we) hereby adopt this plan and subdivision with my (our) free consent and upon approval by the city-county planning board of Winston-Salem and Forsyth county authorize that this plat be recorded in the office of the Register of Deeds, Clerk of Forsyth County.  
Date 2-16-06 signed by: Hubbard Realty  
Date 2-16-06 signed by: James R. Kepley Owner

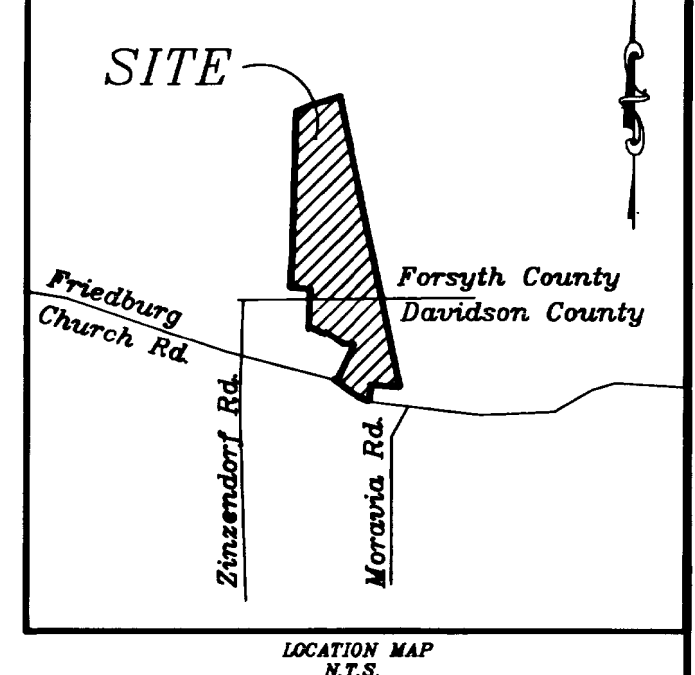

NOTE: This survey is subject to any facts that may be disclosed by a full and accurate title search, NOT furnished to me as of this date, and may be subject to easements, rights-of-way, restrictive covenants, assessments, if any, as the same may appear of record in the Office of the Register of Deeds, Clerk of Court, Town or County Tax Office or which may have been acquired by prescriptive use.

Section 1  
Total Lots: 113  
Lots in Davidson County: 19  
Lots in Forsyth County: 90 (Zoned RS-9)  
Lots in Forsyth & Davidson Counties: 4  
Total Acreage: 15.56ac±  
Acreage in Davidson County: 677,952 sq.ft  
Acreage in Forsyth County: 35.97ac±  
1,566,751 sq.ft.

LEGEND  
EIP.....Existing Iron Pipe Found w/size  
NIP.....New 3/4" Iron Pipe Set  
Stone.....Old Planted Field Stone Found  
REBAR.....Existing Steel Reinforcing Rod found w/size  
Pt.....Point on Ground, no monument found or set  
NAE.....Negative Access Easement

The purpose of the rerecording in Forsyth County of this plat is to correct the dimensions and areas of the following lots 3,4,9,13, 18,19,20,111,113

Previously Recorded in PB,49,Pg.141-144  
Revised 01/31/2006 by JDB

# 02059  
Revised  
BORDER CREEK  
Owner/Developer  
Hubbard Realty of Winston-Salem Inc  
McQuire Construction Co. Inc  
2810 Cloverdale Ave.  
Winston-Salem, NC 27103  
(336) 723-0303

FIELD WORK BY: CJ	CHECKED BY: JEB
TAX MAP: Davidson Co. Tax Map No. 2 Forsyth Co. Tax Map No. 618822	PARCEL: Davidson Co. Lots 15, 22 & 25 Forsyth Co. Lot: 7, B1 3882
TOWNSHIP: Arcadia South Fork	CITY: Winston-Salem
COUNTY: Davidson Forsyth	STATE: NC
DATE: 12-10-2005	SHEET NUMBER: 1 of 4
JOB NUMBER: 02209	DRAWN BY: TLBN

BEESON ENGINEERING INC.  
ENGINEERS SURVEYORS PLANNERS  
603 HIGH STREET  
WINSTON-SALEM, NC 27101  
TELEPHONE: 336-748-0071  
WWW.BEESONENGINEERING.COM

CENTERLINE CURVE DATA

CURVE	LENGTH	RADIUS	BEARING	CHORD
1	234.20	350.00	S58°44'49"W	228.85
2	170.72	250.00	N31°38'48"W	167.42
3	920.61	960.00	S23°44'14"E	885.73

# See revised recorded plat in Davidson County PB 47, PG 37 for lots 18, 19 & 20

\* See revised recorded plat in Forsyth County PB 50, PG 8 for lot 17, 21, 22, 23, 24, 28 & 29

NORTH CAROLINA DEPARTMENT OF TRANSPORTATION  
DIVISION OF HIGHWAYS  
PROPOSED SUBDIVISION ROAD CONSTRUCTION  
STANDARD CERTIFICATION  
APPROVED \_\_\_\_\_  
DISTRICT ENGINEER  
This the \_\_\_\_\_ Day of \_\_\_\_\_ 2006  
NORTH CAROLINA - FORSYTH COUNTY

PLANNING DEPARTMENT/REVIEW OFFICER  
FINAL SUBDIVISION PLAT APPROVAL  
This is to certify that this plat meets the recording requirements  
of the Unified Development Ordinance Subdivision Regulations for  
Winston-Salem, Forsyth County.  
I, David E. Reed  
Review Officer of Forsyth County, certify that the map or plat  
to which this certification is affixed meets all statutory requirements  
for recording.  
Approved: David E. Reed  
Director of Planning/Review Officer  
This the 16th day of February 2006  
NORTH CAROLINA - FORSYTH COUNTY

SURVEYORS CERTIFICATION  
I, John E. Beeson certify that this plat was drawn under  
my supervision from an actual survey made under my supervision  
(description recorded in Deed Book \_\_\_\_\_ Page \_\_\_\_\_ or Plat Book  
\_\_\_\_\_, if applicable); that the ratio of precision as calculated  
is 1/1000; that this plat was prepared in accordance with G.S.  
47-30 as amended. Witness my original signature, registration number  
and seal this 15 day of Feb, A.D., 2006.  
John E. Beeson  
Surveyor  
L-1828  
Registration Number  
NORTH CAROLINA - FORSYTH COUNTY

I, John E. Beeson Professional Land Surveyor, Number 1828, certify to one  
of the following as indicated by an X:  
a. That this plat is of a survey that creates a subdivision of land within the area  
of a county or municipality that has an ordinance that regulates parcels of land;  
b. That this plat is of a survey that is located in such portion of a county or  
municipality that is unregulated as to an ordinance that regulates parcels of land;  
X. That this plat is of a survey of an existing parcel or parcels of land;  
c. That this plat is of a survey of another category, such as the recombination of existing  
parcels, a court-ordered survey or other exception to the definition of a subdivision;  
e. That the information available to this surveyor is such that I am unable to make a  
determination to the best of my professional ability as to provisions contained in  
through d. above.  
John E. Beeson  
Surveyor  
L-1828  
Registration Number  
NORTH CAROLINA - FORSYTH COUNTY

FORSYTH COUNTY REGISTER OF DEEDS  
PLAT REGISTRATION  
Filed for Registration at 8:47 o'clock  
This the 19 day of Feb, 2006, and recorded  
in Plat Book 49, Page 175  
Filing Fee Paid: 21  
Dickie G. Wood, Register of Deeds  
Blampfle  
Deputy Assessor

The undersigned hereby acknowledge that I am (we are) the  
owner(s) of the property shown and described hereon and that  
I (we) hereby adopt this plan and subdivision with my (our)  
free consent and upon approval by the city-county planning  
board of Winston-Salem and Forsyth County authorize that  
this plat be recorded in the office of the register of  
deeds of Forsyth County.  
2-16-06 signed by Hubbard Realty of Winston-Salem, Inc.  
Date  
2-16-06 signed by James R. Hubbard, III  
Date  
Owner

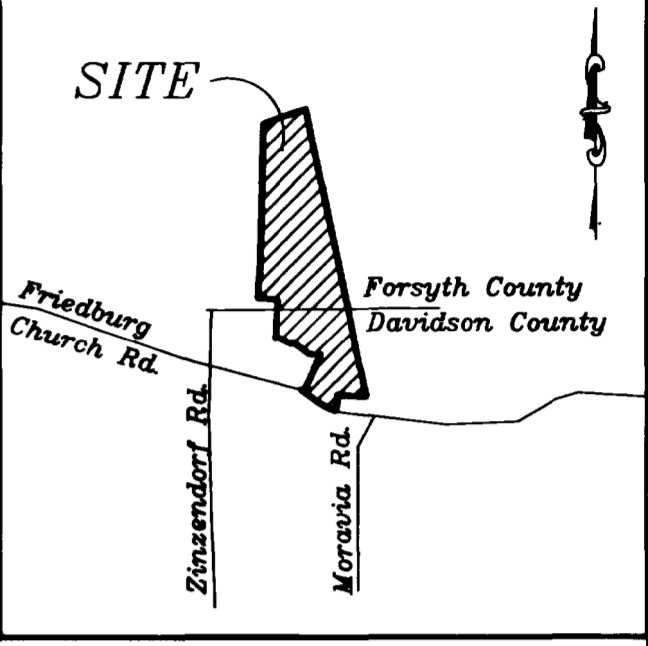

BOOK 49 PAGE 175

Part of  
Tax Lot 7, Block 3882  
Hubbard Realty of  
Winston-Salem, Et Al  
DB 2298, Pg 1019

RIGHT-OF-WAY CURVE DATA				
CURVE	LENGTH	RADIUS	BEARING	CHORD
C7	22.23	14.50	S05°08'10"E	20.12
C8	19.98	23.50	S63°08'44"E	19.38
C9	18.50	50.00	N78°02'55"E	18.42
C10	84.20	50.00	N31°48'50"E	59.88
C11	50.28	50.00	N33°45'59"E	48.17
C12	41.32	50.00	N86°14'21"E	40.16
C13	59.47	50.00	S36°00'32"W	56.03
C14	10.34	50.00	S03°59'38"E	10.32
C15	19.98	23.50	N14°28'06"E	19.38
C16	24.57	14.50	N87°19'53"E	21.73
C17	216.88	935.00	S37°28'57"E	216.40
C18	88.55	935.00	S28°05'21"E	86.54
C19	78.01	935.00	S23°43'16"E	75.99
C20	72.23	935.00	S19°10'45"E	72.21
C21	89.57	935.00	S14°13'18"E	89.54
C22	116.61	935.00	S07°54'16"E	116.53
C23	76.68	935.00	S01°58'56"E	76.68
C24	54.96	935.00	S02°03'04"W	54.96
C25	21.21	13.50	S48°44'06"E	19.09
C26	18.54	525.00	S87°10'03"E	18.54
C27	73.53	525.00	N87°55'05"E	73.47
C28	48.28	525.00	N81°22'47"E	48.28
C29	19.98	23.50	N76°47'27"W	19.38
C30	33.50	50.00	S71°37'39"E	32.87
C31	40.84	50.00	N85°48'56"E	39.71
C32	41.46	50.00	N18°37'50"E	40.28
C33	44.11	50.00	N30°23'39"W	42.89
C34	41.19	50.00	N79°15'58"W	40.03
C35	41.01	50.00	S53°38'19"W	39.87
C36	19.98	23.50	N54°29'55"E	19.38
C37	97.73	475.00	N84°44'53"E	97.56
C38	25.84	475.00	S87°48'41"E	25.84
C39	25.19	13.50	S32°49'12"E	21.89
C107	51.12	275.00	S15°17'59"W	51.04
C108	29.95	275.00	S06°51'17"W	29.93
C109	12.12	985.00	S03°22'57"W	12.12
C110	71.11	985.00	S00°57'42"W	71.09
C111	65.86	985.00	S03°01'19"E	65.84
C112	83.76	985.00	S06°47'30"E	83.75
C113	80.87	985.00	S10°59'32"E	80.85
C114	88.28	985.00	S15°19'28"E	88.27
C115	72.70	985.00	S19°25'29"E	72.68
C116	116.87	985.00	S24°56'17"E	118.80
C117	107.58	985.00	S31°27'58"E	107.53
C118	89.02	985.00	S37°11'02"E	88.99
C119	89.49	985.00	S42°22'32"E	89.45
C120	90.21	985.00	S47°38'07"E	90.18
C121	18.92	985.00	S50°43'04"E	18.92
C122	153.85	225.00	N31°38'48"W	150.88
C123	21.21	13.50	N32°54'58"E	19.09
C124	250.92	375.00	S58°44'49"W	246.27

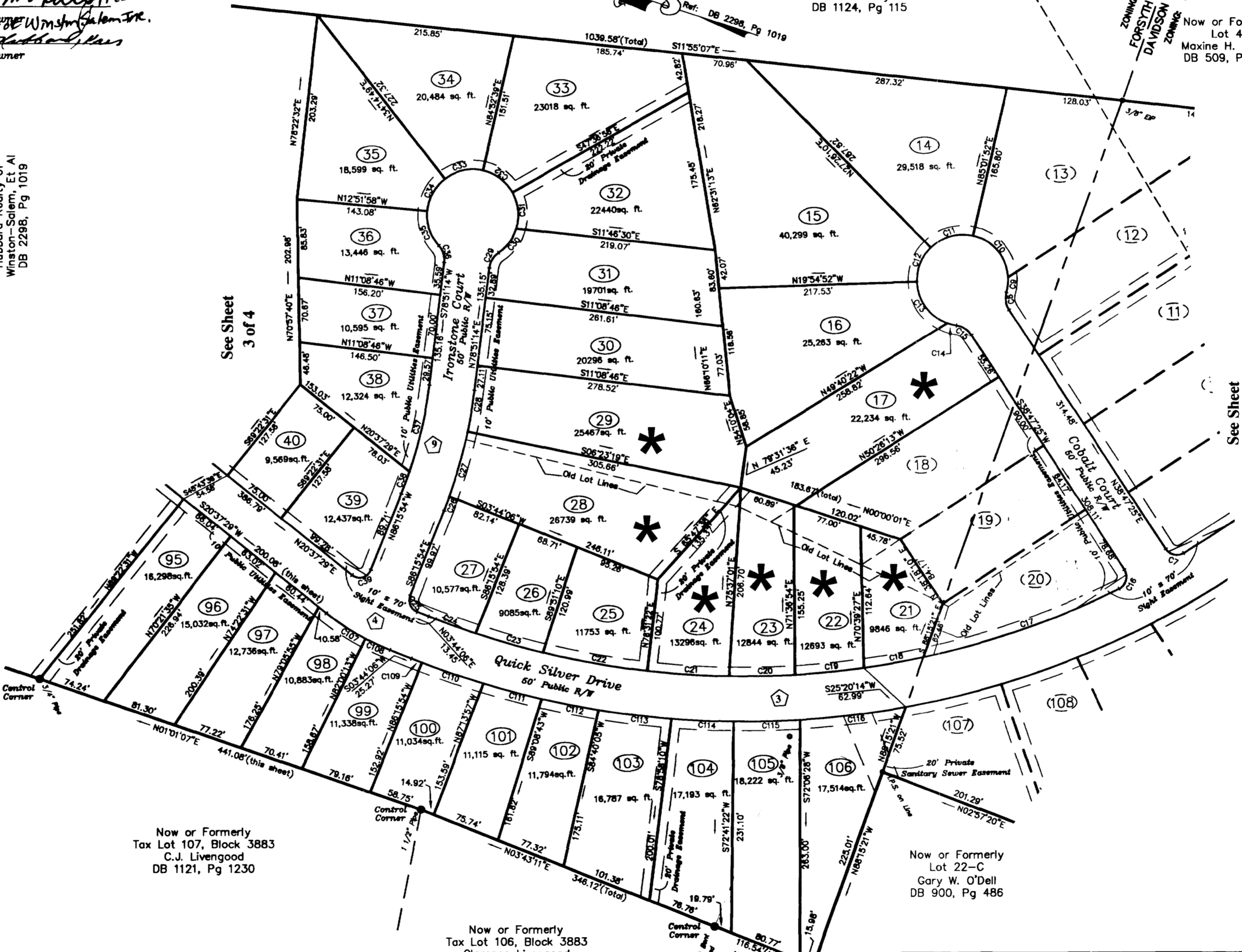

NOTE:  
This survey is subject to any facts that may be  
disclosed by a full and accurate title search, NOT  
furnished to me as of this date, and may be subject  
to easements, rights-of-way, restrictive covenants,  
assessments, if any, as the same may appear of  
record in the Office of the Register of Deeds, Clerk  
of Court, Town or County Tax Office or which may  
have been acquired by prescriptive use.

Section 1  
Total Lots: 113  
Lots in Davidson County: 19  
Lots in Forsyth County: 90 (Zoned RS-9)  
Lots in Forsyth & Davidson Counties: 4  
Total Acreage:  
Acreage in Davidson County: 15.56ac±  
677,952 sq.ft  
Acreage in Forsyth County: 35.97ac±  
1,566,751 sq.ft  
LEGEND  
EIP.....Existing Iron Pipe Found w/size  
NIP.....New 3/4" Iron Pipe Set  
Sts.....Old Planted Field Stone Found  
REBAR.....Existing Steel Reinforcing Rod  
found w/size  
Pt.....Point on Ground, no monument  
found or set  
NAE.....Negative Access Easement

The purpose of the rerecording of this plat  
is to correct the dimensions and areas of  
the following lots 15,16,17,18,19,20,21,22,23  
24,25,26,28,29,30,31,32,31  
Revised 01/31/2006 by JDB

Previously Recorded in PB,49,Pg.141-144

CENTERLINE CURVE DATA				
CURVE	LENGTH	RADIUS	BEARING	CHORD
3	920.61	960.00	S23°44'14"E	885.73
4	73.70	250.00	N12°10'48"E	73.43
9	129.86	500.00	N86°17'40"E	129.50

# 02059  
Revised  
BORDER CREEK  
Owner/Developer  
Hubbard Realty of Winston-Salem Inc  
McCuire Construction Co. Inc  
2110 Cloverdale Ave.  
Winston-Salem, NC 27103  
(336) 723-0303  
SCALE: 1" = 100'  
100 50 0 50 100 200  
FIELD WORK BY: CJ  
CHECKED BY: JEB  
TAX MAP: Davidson Co. Tax Map No. 2  
Forsyth Co. Tax Map No. 619822  
PARCEL: Davidson Co. Lots 15, 22 & 25  
Forsyth Co. Lot 7, Bl 3882  
TOWNSHIP: Arcadia  
South Fork  
CITY:  
COUNTY: Davidson  
Forsyth  
STATE: NC  
DATE: 12-10-2005  
SHEET NUMBER:  
JOB NUMBER: 02209  
DRAWN BY: TLBN  
2 of 4  
BEESON ENGINEERING INC.  
ENGINEERS SURVEYORS PLANNERS  
603 HIGH STREET  
WINSTON-SALEM, NC 27101  
TELEPHONE: 336-748-0071  
WWW.BEESONENGINEERING.COM

\* See revised recorded plat in Forsyth County PB 50, Pg 8 for lots 17, 21, 22, 23, 24, 28 & 29

**NORTH CAROLINA DEPARTMENT OF TRANSPORTATION  
DIVISION OF HIGHWAYS**

PROPOSED SUBDIVISION ROAD CONSTRUCTION  
STANDARD CERTIFICATION

APPROVED \_\_\_\_\_  
DISTRICT ENGINEER

This the \_\_\_\_\_ Day of \_\_\_\_\_ 19\_\_\_\_  
NORTH CAROLINA - FORSYTH COUNTY

**PLANNING DEPARTMENT/REVIEW OFFICER  
FINAL SUBDIVISION PLAT APPROVAL**

This is to certify that this plat meets the recording requirements of the Unified Development Ordinance Subdivision Regulations for Winston-Salem, Forsyth County.

I, David E. Reed, Review Officer of Forsyth County, certify that the map or plat to which this certification is affixed meets all statutory requirements for recording.

Approved \_\_\_\_\_  
David E. Reed  
Review Officer of Forsyth County  
This the 16 day of February 2006  
NORTH CAROLINA - FORSYTH COUNTY

**SURVEYORS CERTIFICATION**

I, John E. Beeson, certify that this plat was drawn under my supervision from an actual survey made under my supervision (description recorded in Deed Book \_\_\_\_\_ Page \_\_\_\_\_ or Plat Book \_\_\_\_\_ if applicable); that the ratio of precision as calculated is 1:10,000; that this plat was prepared in accordance with G.S. 47-30 as amended. Witness my original signature, registration number and seal this 15 day of Feb A.D. 2006.

John E. Beeson  
Surveyor  
1-1828  
Registration Number  
NORTH CAROLINA - FORSYTH COUNTY

I, JOHN E. BEESON, Professional Land Surveyor, No. 1828, certify to one of the following as indicated by an X:

a. That this plat is of a survey that creates a subdivision of land within the area of a county or municipality that has an ordinance that regulates parcels of land;

b. That this plat is of a survey that is located in such portion of a county or municipality that is unregulated as to an ordinance that regulates parcels of land;

c. That this plat is of a survey of an existing parcel or parcels of land;

d. That this plat is of a survey of another category, such as the recombination of existing parcels, a court-ordered survey or other exception to the definition of a subdivision;

e. That the information available to this surveyor is such that I am unable to make a determination to the best of my professional ability as to provisions contained in through it above.

John E. Beeson  
Surveyor  
1-1828  
Registration Number  
NORTH CAROLINA - FORSYTH COUNTY

**FORSYTH COUNTY REGISTER OF DEEDS  
PLAT REGISTRATION**

Filed for Registration on 8:47 o'clock A.M.  
This the 19 day of Feb 2006 and recorded in Plat Book 49 Page 176

Filing Fee Paid: \_\_\_\_\_  
Dixie B. Wood, Register of Deeds  
D. Compere  
Deputy - Absent

RIGHT-OF-WAY CURVE DATA				
CURVE	LENGTH	RADIUS	BEARING	CHORD
C40	21.21	13.50	S85°37'29"W	19.09
C41	19.98	23.50	N45°01'12"W	19.38
C42	42.61	50.00	S45°04'49"E	41.34
C43	56.67	50.00	N78°02'15"E	53.88
C44	33.87	50.00	N26°10'00"E	33.22
C45	38.08	50.00	N13°54'39"W	35.30
C46	38.56	50.00	N57°15'01"W	38.54
C47	33.31	50.00	S80°59'57"W	32.70
C48	19.98	23.50	N86°16'10"E	19.38
C49	21.21	13.50	S24°22'31"E	19.09
C50	68.02	275.00	N13°32'22"E	67.84
C51	50.77	275.00	N01°09'53"E	50.70
C52	19.40	13.50	S37°02'28"W	17.77
C53	19.40	13.50	S60°37'41"E	17.77
C54	65.38	275.00	N28°16'18"W	65.21
C55	52.97	275.00	N38°35'54"W	52.89
C56	14.62	275.00	N45°38'22"W	14.61
C57	68.72	175.00	S35°54'44"E	66.28
C58	26.42	13.50	S31°23'35"W	22.40
C59	91.62	525.00	N82°26'57"E	91.50
C60	42.14	525.00	N75°09'02"E	42.13
C61	19.98	23.50	N62°47'37"W	19.38
C62	58.47	50.00	N88°03'34"E	55.20
C63	55.40	50.00	N22°48'47"E	52.61
C64	44.07	50.00	N34°11'02"W	42.66
C65	37.61	50.00	N80°59'03"W	36.73
C66	48.54	50.00	S50°48'15"E	44.88
C67	19.98	23.50	N48°29'45"E	19.38
C68	60.34	475.00	N76°29'24"E	60.30
C69	72.13	475.00	N84°28'47"E	72.07
C70	21.82	13.50	S44°51'24"E	19.52
C71	61.58	250.00	S08°30'45"W	61.42
C88	39.80	300.00	S05°15'27"W	39.78
C89	20.50	13.50	N44°57'27"E	18.59
C90	17.57	13.50	N54°15'44"W	16.35
C91	31.88	225.00	S21°02'29"E	31.86
C92	57.01	225.00	S32°21'31"E	56.86
C93	29.63	225.00	S43°23'22"E	29.61
C94	33.11	225.00	N42°56'46"W	33.08
C95	148.14	225.00	N20°07'23"W	143.59
C96	66.95	225.00	N09°33'16"E	66.41
C97	21.21	13.50	N65°37'29"E	19.09
C98	19.98	23.50	S45°01'12"W	19.38
C99	3.15	50.00	N22°28'14"W	3.15
C100	60.59	50.00	N58°59'20"W	56.96
C101	48.87	50.00	S59°28'36"W	45.17
C102	68.24	50.00	S08°30'44"E	63.07
C103	60.09	50.00	S80°02'37"E	56.54
C104	3.15	50.00	N63°43'12"E	3.15
C105	19.98	23.50	S86°16'10"W	19.38
C106	21.21	13.50	N24°22'31"W	19.09

The undersigned hereby acknowledge that I am (we are) the owners of the property shown and described hereon and that I (we) hereby adopt this plan and subdivision with my (our) free consent and upon approval by the city-county planning board of Winston-Salem and Forsyth County authorize that this plat be recorded in the office of the register of deeds of Forsyth County.

1-16-06 signed by [Signature]  
Date \_\_\_\_\_ Owner \_\_\_\_\_  
2-16-06 signed by [Signature]  
Date \_\_\_\_\_ Owner \_\_\_\_\_

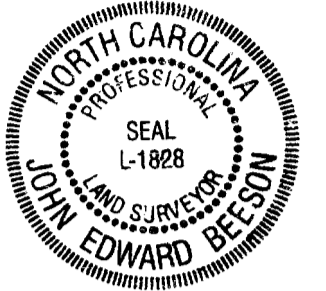

49 176

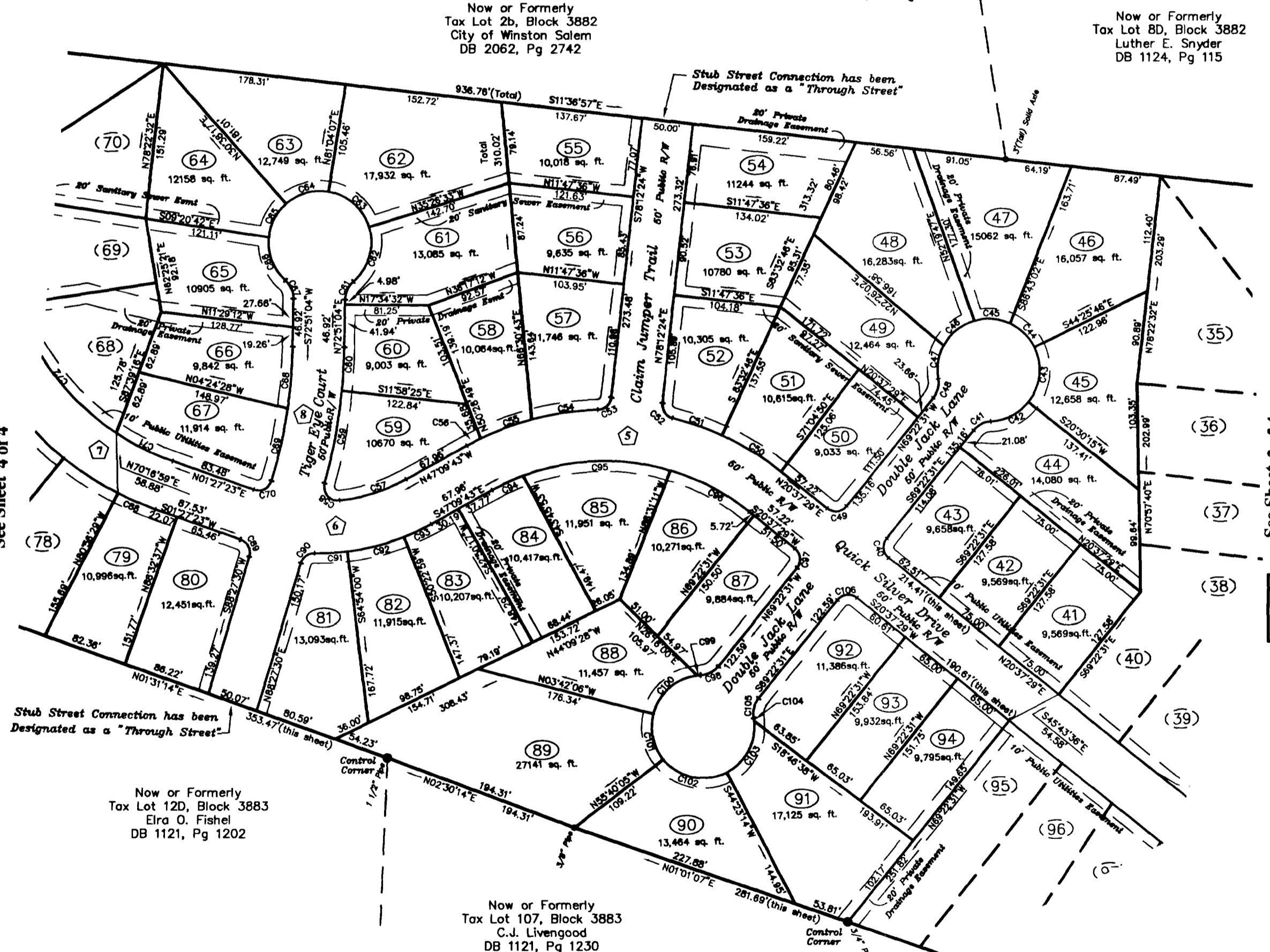
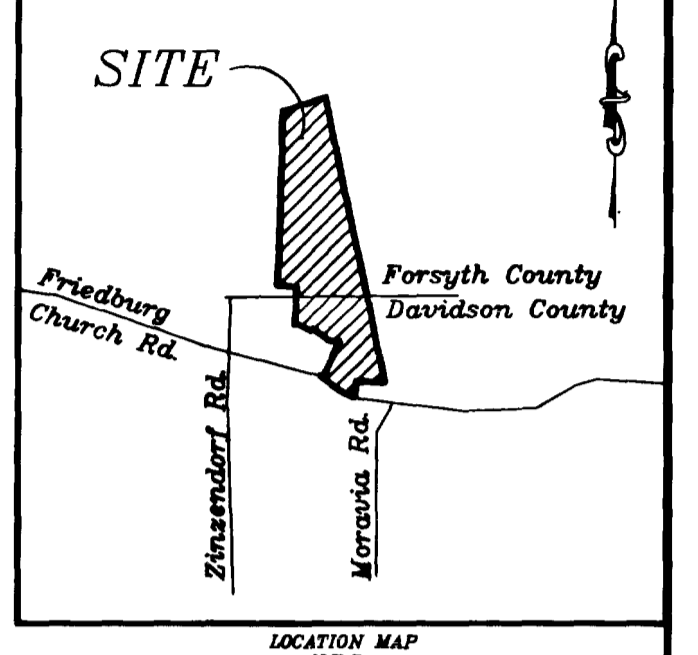

NOTE: This survey is subject to any facts that may be disclosed by a full and accurate title search, NOT furnished to me as of this date, and may be subject to assessments, rights-of-way, restrictive covenants, assessments, if any, as the same may appear of record in the Office of the Register of Deeds, Clerk of Court, Town or County Tax Office or which may have been acquired by prescriptive use.

**Section 1**  
Total Lots: 54  
Lots in Davidson County: 19  
Lots in Forsyth County: 90  
Lots in Forsyth & Davidson Counties: 4

Total Acreage:  
Acreage in Davidson County: 15.56ac  
Acreage in Forsyth County: 677,952 sq.ft  
Acreage in Forsyth & Davidson Counties: 734,474 sq.ft.

**LEGEND**  
RIP.....Existing Iron Pipe Found w/size  
NIP.....New 3/4" Iron Pipe Set  
Stone.....Old Planted Field Stone Found  
REBAR.....Existing Steel Reinforcing Rod found w/size  
Pt.....Point on Ground, no monument found or set  
NAE.....Negative Access Easement

The purpose of the rerecording of this plat is to correct the dimensions and areas of the following lots 47,53,54,59,64,65,88 Revised 01/31/2006 by JDB

Previously Recorded in PB, 49, Pg. 141-144

CURVE	LENGTH	RADIUS	BEARING	CHORD
5	295.78	250.00	N13°16'07"W	278.82
6	169.71	200.00	S22°51'10"E	164.66
7	316.17	275.00	S34°23'36"W	299.04

# 02059

Revised  
**BORDER CREEK**

Owner/Developer  
**HUBBARD REALTY**

2110 Cloverdale Ave.  
Winston-Salem, NC 27103  
(336) 723-0303

SCALE: 1" = 100'

FIELD WORK BY CJ	CHECKED BY JEB	
TAX MAP: Davidson Co. Tax Map No. 2	PARCEL: Davidson Co. Lots 13, 22 & 25 Forsyth Co. Tax Map No. 818822 Forsyth Co. Lot 7, B1 3882	
TOWNSHIP: Arcadia South Fork	CITY: Winston-Salem	COUNTY: Davidson Forsyth
STATE: NC	DATE: 10-21-2005	SHEET NUMBER: 3 of 4
JOB NUMBER: 02209	DRAWN BY: TLBN	

**BEESON ENGINEERING INC.**  
ENGINEERS SURVEYORS PLANNERS

605 HIGH STREET  
WINSTON-SALEM, NC 27101  
TELEPHONE: 336-748-0071  
WWW.BEESONENGINEERING.COM

**NORTH CAROLINA DEPARTMENT OF TRANSPORTATION**  
**DIVISION OF HIGHWAYS**  
 PROPOSED SUBDIVISION ROAD CONSTRUCTION  
 STANDARDS CERTIFICATION  
 APPROVED \_\_\_\_\_ DISTRICT ENGINEER  
 This the \_\_\_\_\_ Day of \_\_\_\_\_ 2006  
 NORTH CAROLINA - FORSYTH COUNTY

**PLANNING DEPARTMENT/REVIEW OFFICER**  
**FINAL SUBDIVISION PLAT APPROVAL**  
 This is to certify that this plat meets the recording requirements of the Unified Development Ordinance Subdivision Regulations for Winston-Salem, Forsyth County.  
 I, David E. Reed, Review Officer of Forsyth County, certify that the map or plan to which this certification is affixed meets all statutory requirements for recording.  
 Approved: David E. Reed  
 Director of Planning/Review Officer  
 This the 16 day of February, 2006  
 NORTH CAROLINA - FORSYTH COUNTY

**SURVEYORS CERTIFICATION**  
 I, John E. Beeson, certify that this plat was drawn under my supervision from an actual survey made under my supervision (description recorded in Deed Book \_\_\_\_\_ Page \_\_\_\_\_ or Plat Book \_\_\_\_\_ Page \_\_\_\_\_ if applicable); that the ratio of precision as calculated is 1:10,000; that this plat was prepared in accordance with G.S. 47-30 as amended. Witness my original signature, registration number and seal this 15 day of FEB, A.D. 2006.  
John E. Beeson  
 L-1828  
 Surveyor  
 Registration Number  
 NORTH CAROLINA - FORSYTH COUNTY

I, JOHN E. BEESON, Professional Land Surveyor, Number 1828, certify to one of the following as indicated by an X:  
 a. That this plat is of a survey that creates a subdivision of land within the area of a county or municipality that has an ordinance that regulates parcels of land;  
 b. That this plat is of a survey that is located in such portion of a county or municipality that is unregulated as to an ordinance that regulates parcels of land;  
 X c. That this plat is of a survey of an existing parcel or parcels of land;  
 d. That this plat is of a survey of another category, such as the recombination of existing parcels, a court-ordered survey or other exception to the definition of a subdivision;  
 e. That the information available to this surveyor is such that I am unable to make a determination to the best of my professional ability as to provisions contained in a through d above.  
John E. Beeson  
 L-1828  
 Surveyor  
 Registration Number  
 NORTH CAROLINA - FORSYTH COUNTY

**FORSYTH COUNTY REGISTER OF DEEDS**  
**PLAT REGISTRATION**  
 Filed for Registration at 8:47 o'clock A.M.  
 This the 16 Day of Feb, 2006 and recorded in Plat Book 49, Page 177.  
 Filing Fee Paid: 21  
 Dickie C. Wood, Register of Deeds  
B. Canales  
 Deputy - Assistant

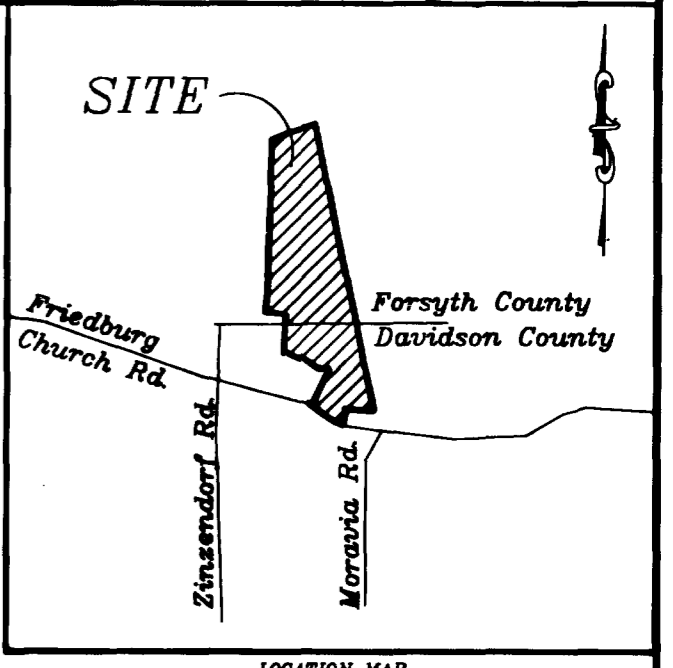
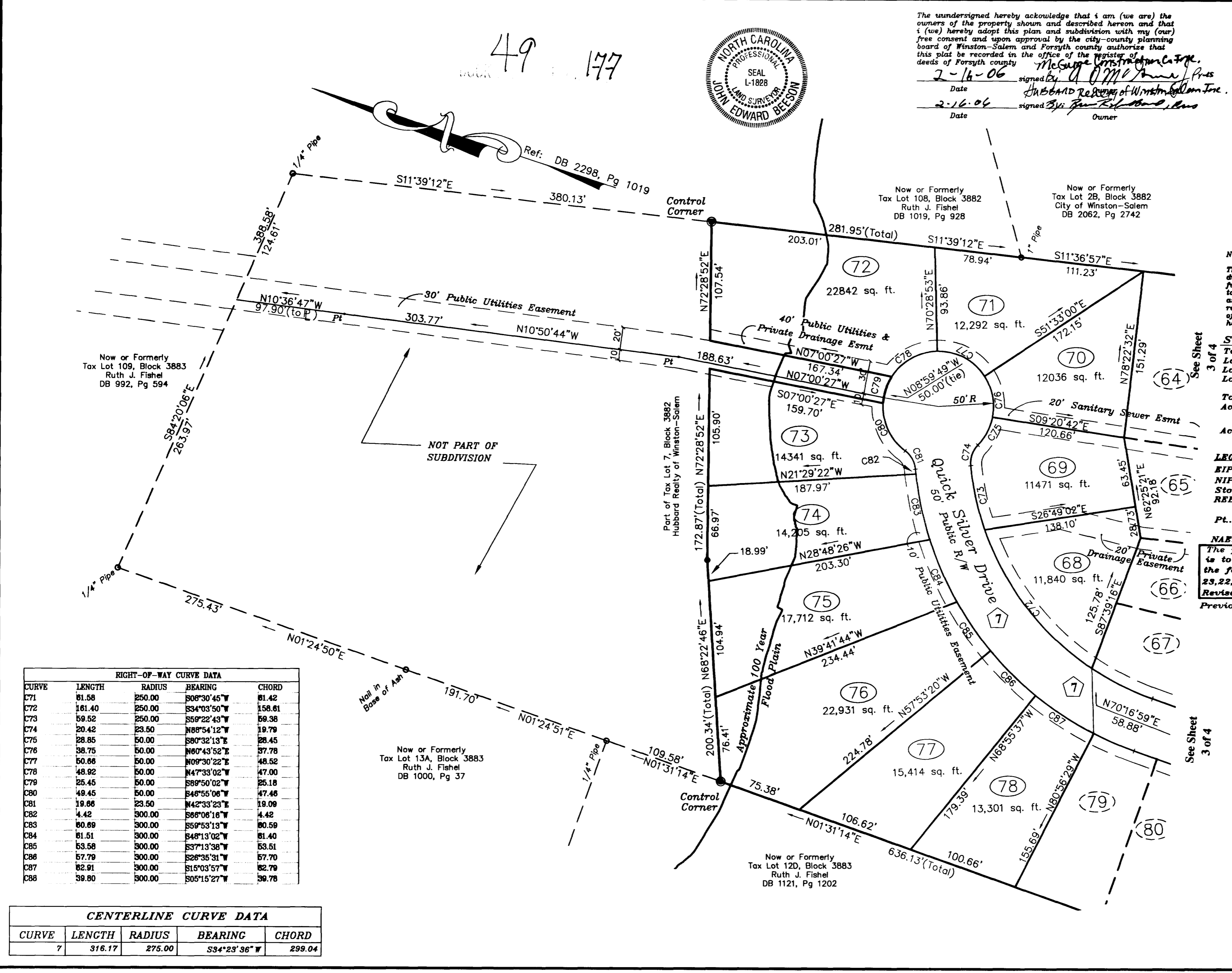

**NOTE:**  
 This survey is subject to any facts that may be disclosed by a full and accurate title search, NOT furnished to me as of this date, and may be subject to easements, rights-of-way, restrictive covenants, assessments, if any, as the same may appear of record in the Office of the Register of Deeds, Clerk of Court, Town or County Tax Office or which may have been acquired by prescriptive use.

**Section 1**  
 Total Lots: 113  
 Lots in Davidson County: 19  
 Lots in Forsyth County: 90 (Zoned RS-9)  
 Lots in Forsyth & Davidson Counties: 4

Total Acreage:  
 Acreage in Davidson County: 15.66ac±  
 677,952 sq.ft.  
 Acreage in Forsyth County: 35.97ac±  
 1,566,751 sq.ft.

**LEGEND**  
 EIP.....Existing Iron Pipe Found w/size  
 NIP.....New 3/4" Iron Pipe Set  
 Stone.....Old Planted Field Stone Found  
 REBAR.....Existing Steel Reinforcing Rod found w/size  
 Pt.....Point on Ground, no monument found or set  
 NAE.....Negative Access Easement

The purpose of the rerecording of this plat is to correct the dimensions and areas of the following lots 69,70,72,73, 74, 75, 76, 77, 78, 79, 80.  
 Revised 01/31/2006 by JDB  
 Previously Recorded in PB,49,Pg.141-144

**RIGHT-OF-WAY CURVE DATA**

CURVE	LENGTH	RADIUS	BEARING	CHORD
C71	61.58	250.00	S08°30'45"W	61.42
C72	161.40	250.00	S34°03'50"W	158.61
C73	59.52	250.00	S59°22'43"W	59.38
C74	20.42	23.50	N88°54'12"W	19.79
C75	28.85	50.00	S80°32'13"E	28.45
C76	38.75	50.00	N60°43'52"E	37.78
C77	50.86	50.00	N09°30'22"E	48.52
C78	48.92	50.00	N47°33'02"W	47.00
C79	25.45	50.00	S89°50'02"W	25.18
C80	49.45	50.00	S46°55'06"W	47.46
C81	19.86	23.50	N42°33'23"E	19.09
C82	4.42	300.00	S66°06'16"W	4.42
C83	60.89	300.00	S59°53'13"W	60.59
C84	61.51	300.00	S48°13'02"W	61.40
C85	53.58	300.00	S37°13'38"W	53.51
C86	57.79	300.00	S26°35'31"W	57.70
C87	62.81	300.00	S15°03'57"W	62.79
C88	39.80	300.00	S05°15'27"W	39.78

**CENTERLINE CURVE DATA**

CURVE	LENGTH	RADIUS	BEARING	CHORD
7	316.17	275.00	S34°23'36"W	299.04

# 02059  
 Revised  
**BORDER CREEK**  
 Owner/Developer  
 Hubbard Realty of Winston-Salem Inc  
 McCuthe Construction Co. Inc  
 2110 Cloverdale Ave.  
 Winston-Salem, NC 27103  
 (336) 723-0303

SCALE: 1" = 60'

FIELD WORK BY: CJ  
 CHECKED BY: JEB

TAX MAP: Davidson Co. Tax Map No. 2  
 Forsyth Co. Tax Map No. 61882  
 PARCEL: Davidson Co. Lots 15, 25 & 26  
 Forsyth Co. Lot 7, Bl 3882

TOWNSHIP: Arcadia  
 South Fork  
 CITY: Davidson  
 COUNTY: Davidson  
 Forsyth

STATE: NC  
 DATE: 12-10-2006  
 SHEET NUMBER: 4 of 4

JOB NUMBER: 02209  
 DRAWN BY: TLBN

**BEESON ENGINEERING INC.**  
 ENGINEERS SURVEYORS PLANNERS  
 603 HIGH STREET  
 WINSTON-SALEM, NC 27101  
 TELEPHONE: 336-748-0071  
 WWW.BEESONENGINEERING.COM

